



Meitong Tech

ZHEJIANG MEITONG CONDUCTOR TECHNOLOGY CO.,LTD

📍 No.102,Building 5, No.2968 Huling Road, Linghu Town,
Nanxun District,Huzhou City, Zhejiang Province, China

☎ +86 0572 2107909

✉ Info@meitongtech.com chris@meitongtech.com

🌐 www.meitongtech.com

HIGH VISION NEW HORIZON



Meitong Tech

www.meitongtech.com

PROFESSIONAL

Customers worldwide located

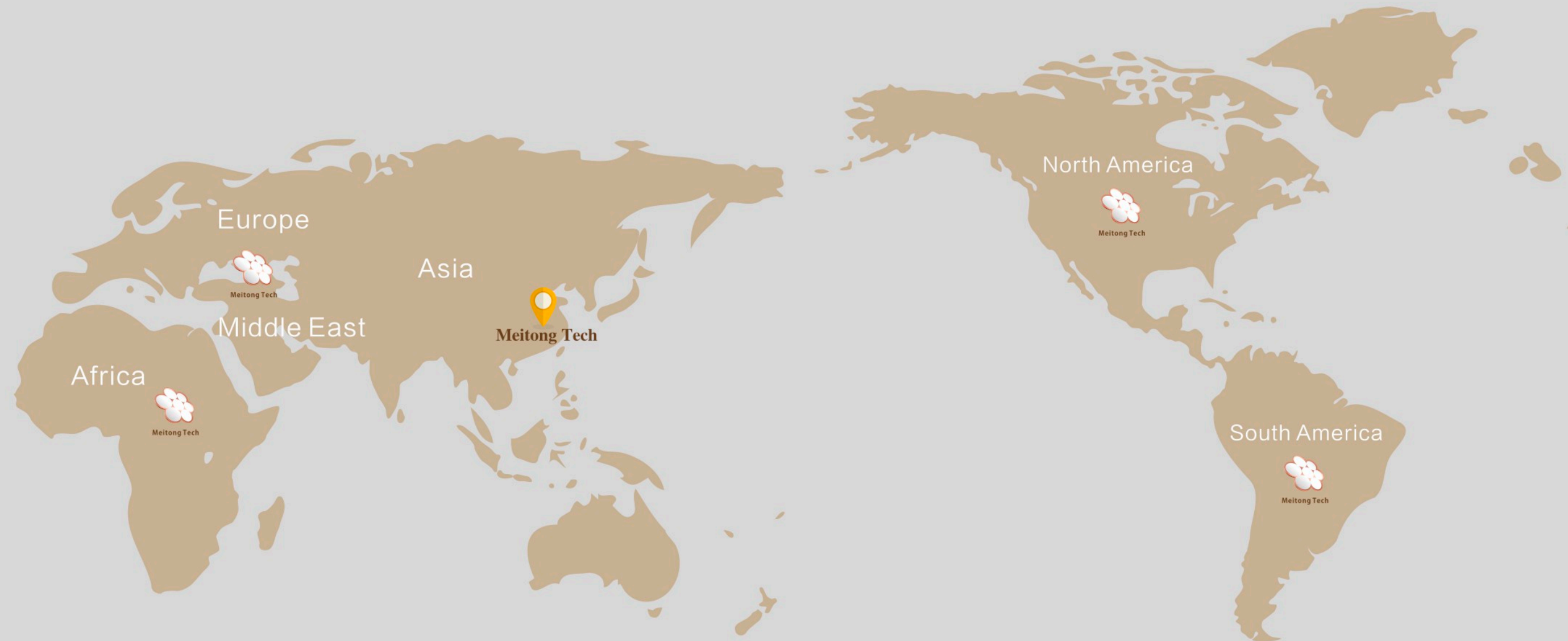



Meitong Tech

•Russia

•Canada

•Europe

•United States

Production Workshop

www.meitongtech.com

PROFESSIONAL



Testing Center



•Russia

Canada

•United States

•China



Meitong Tech

www.meitongtech.com

PROFESSIONAL

•Russia

•Canada

•Europe

•United States

•China



Contents

CCA-Copper Clad Aluminum	07-08
CCA Stranded & Bunched Wire	09-10
CCS - Copper Clad Steel	11-12
CCS Stranded & Bunched Wire	13-14
Coaxial Cable	15-16
Cat5e 4-pair Utp	17
Cat5e 4-pair Ftp	18
Cat6 4-pair Utp	19
Cat6 4-pair Ftp	20
PVC Insulated THW Stranded Single Cable	21-22

•Russia

•Canada

•United States

•China



CCA-Copper Clad Aluminum



CCA Wire (AWG)							Note:
Technical Characteristics	Clad type				Plated type		
	10H	10A	15H	15A	Hard	Soft	
Size range	0.12mm-8.00mm	0.12mm-8.00mm	0.12mm-8.00mm	0.12mm-8.00mm	0.12mm-8.00mm	0.12mm-8.00mm	All products can be customized upon customer's specific requirements
Copper content (by weight)	25%-31%	25%-31%	32%-40%	32%-40%	10%		
Resistivity (max at 20°C)	0.02743 Ω.mm ² /m	0.02743 Ω.mm ² /m	0.02676 Ω.mm ² /m	0.02676 Ω.mm ² /m	0.02743 Ω .mm ² /m		
Density	3.32g/cm ³	3.32g/cm ³	3.63g/cm ³	3.63g/cm ³	2.85g/cm ³		
Conductivity (min at 20°C)	62%	62%	64%	64%	60%		
Elongation	1%-3%	8%-25%	1%-3%	8%-25%	1%-3%	8%-20%	
Tensile strength	≥250Mpa	≥110Mpa	≥250Mpa	≥110Mpa	≥250Mpa	≥100Mpa	

Application

- 1.Lan cable
- 2.Power cable
- 3.Control cable
- 4.Conductor for coaxial cables
- 5.Construction wiring
- 6.Bus-bar
- 7.Fuse
- 8.Rf shielded cable
- 9.Extension cord

Advantage

- 1.Better price-less expensive than copper, reducing costs of material for cable production.
- 2.Higher conductivity-electrical conductivity much higher than pure aluminum.
- 3.Lighter weight-easy to transport and install thus saves labor cost.

Packaging Details:				
DIN 130mm	DIN 185mm	DIN 250mm	DIN 400mm	DIN 800mm
A:130mm	A:185mm	A:250mm	A:400mm	A:800mm
B:65mm	B:130mm	B:160mm	B:160mm	B:370mm
C:100mm	C:160mm	C:160mm	C:260mm	C:490mm
D:120mm	D:180mm	D:200mm	D:290mm	D:520mm
E:21mm	E:31mm	E:31mm	E:56mm	E:126mm

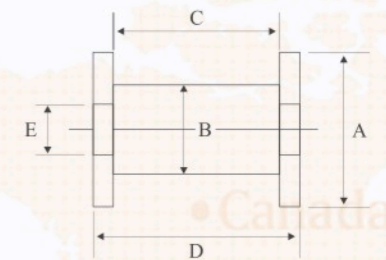



CCA Stranded & Bunched Wire



CCA Stranded & Bunched Wire				
Section area (mm ²)	Structure (number/mm)	Resistance (Ω/km)max	Tensile Strength (Mpa)	Elongation
0.60/0.50	19/0.20	42.20	100-150	1-25
0.75	19/0.23	34.18		
1.00	19/0.26	26.75		
1.5	19/0.32	17.65		
2.00	19/0.36	13.95		
2.50	19/0.41	10.32		
3.00	19/0.47	8.32		
4.00	19/0.53	6.48		
5.00	19/0.59	5.23		
8.00	19/0.73	3.42		
10.00	19/0.82	2.7		
15.00	19/1.01	1.75		
20-400	All technology data and structure are complied customer's request			

Application

- 1.Thw cable
- 2.Extension cable
- 3.Rf cable
- 4.Building cable
- 5.Boost/battery cable
- 6.Welding cable
- 7.Speaker cable

Advantage

- 1.Competitive price –low cost and price than copper.
- 2.Signal transmission – higher transfer speed than aluminum and close to copper.
- 3.Lighter weight– low density for easy install and save labor cost.

Packaging Details:		
DIN 500mm	DIN 630mm	DIN 800mm
A:500mm	A:630mm	A:800mm
B:200mm	B:280mm	B:370mm
C:330mm	C:400mm	C:490mm
D:360mm	D:430mm	D:520mm
E:56mm	E:56mm	E:126mm

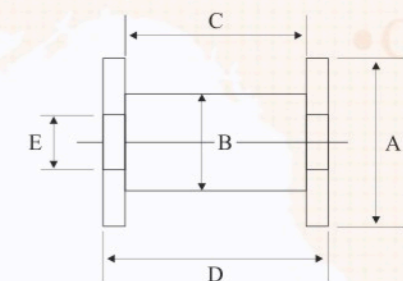



CCS – Copper Clad Steel

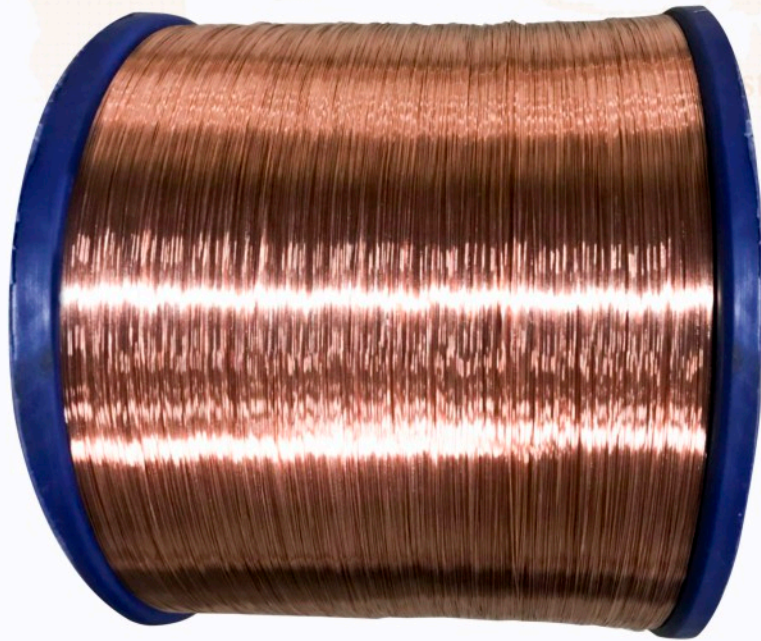

CCS Wire(AWG)					Note:
Technical Characteristics	Conductivity(min at 20°C)				
		15%	18%	21%	30%
Size range	0.12mm-8.00mm	0.12mm-8.00mm	0.12mm-8.00mm	0.12mm-8.00mm	All products can be customized upon customer's specific requirements
Resistivity(max at 20°C)	0.116Ω . mm/m	0.0969Ω . mm/m	0.083Ω . mm/m	0.058Ω . mm/m	
Density	7.88g/cm	7.90g/cm	7.95g/cm	8.10g/cm	
Elongation	H	1%-3%	1%-3%	1%-3%	
	A	8%-25%	8%-25%	8%-25%	
Tensile strength	H	430Mpa-1800Mpa	430Mpa-1800Mpa	430Mpa-1800Mpa	
	A	320Mpa-560Mpa	320Mpa-560Mpa	320Mpa-560Mpa	

Application

- 1.CATV drop cable 2.Coaxial cable 3.Telephone drop wire
- 4.Ground cable 5.Braiding wire for power cable 6.Welding cable
- 7.CP wire

Advantage

- 1.More competitive price than copper.
- 2.Higher tensile strength than copper.

Packaging Details:				
DIN 130mm	DIN 185mm	DIN 250mm	DIN 400mm	DIN 800mm
A:130mm	A:185mm	A:250mm	A:400mm	A:800mm
B:65mm	B:130mm	B:160mm	B:160mm	B:370mm
C:100mm	C:160mm	C:160mm	C:260mm	C:490mm
D:120mm	D:180mm	D:200mm	D:290mm	D:520mm
E:21mm	E:31mm	E:31mm	E:56mm	E:126mm

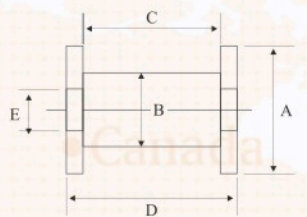



CCS Stranded & Bunched Wire

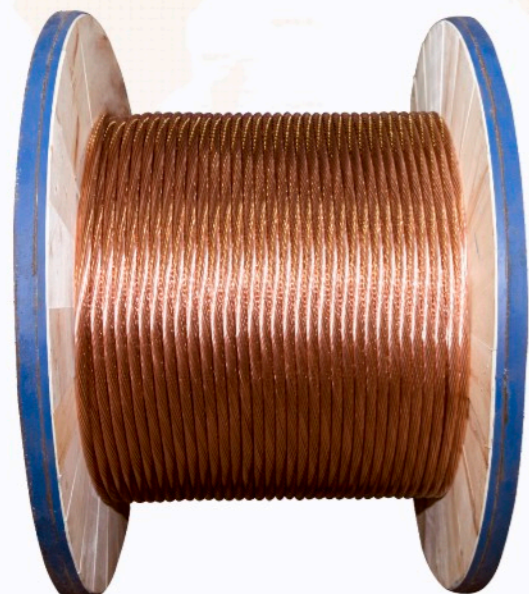

CCS Stranded & Bunched Wire					
Section area (mm ²)	Diameter of single wire(mm)	Number of strand	Diameter of the entire Strand(mm)	Weight for reference(kg/km)	Electrical conductivity of a single wire (%)
16	1.70	7	5.10	130	15-40
25	2.14	7	6.36	200	
35	2.52	7	7.50	280	
50	3.00	7	9.00	400	
	1.80	19			
70	3.50	7	10.60	550	
	2.14	19			
95	2.52	19	12.60	766	
120	2.84	19	14.00	980	
150	3.15	19	15.80	1230	
	2.28	37			
185	3.52	19	17.50	1520	
	2.52	37			
240	4.00	19	20.00	1970	
	2.88	37			
300	3.20	37	22.4	2430	

Application

1. Earth rod for power industry
2. Trolley wire for power transmission
3. Overhead-contact systems for railway
4. Connectors for electronic components
5. Strengthened conductivity wire core for special cable

Advantage

1. Combination of good conductivity, high tensile strength and welding property of copper.
2. High density, good extensibility thus saving copper resource and cost.

Packaging Details:					
DIN 130mm	DIN 185mm	DIN 250mm	DIN 400mm	DIN 630mm	DIN 800mm
A:130mm	A:185mm	A:250mm	A:400mm	A:630mm	A:800mm
B:65mm	B:130mm	B:160mm	B:160mm	B:280mm	B:370mm
C:100mm	C:160mm	C:160mm	C:260mm	C:400mm	C:490mm
D:120mm	D:180mm	D:200mm	D:290mm	D:430mm	D:520mm
E:21mm	E:31mm	E:31mm	E:56mm	E:56mm	E:126mm

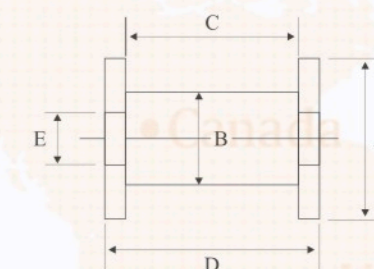

Coaxial Cable

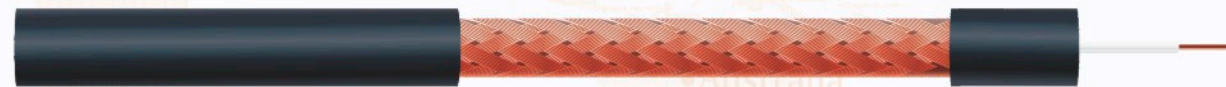

Rg59 Coaxial Cable			
	Options:		Standard Specification
Inner conductor	Material	CCS/COPPER/CCA	0.81mmBare Copper+3.7mmFoam PE +AL Foil+60% Braid+6.1mm PVC
	Diameter	0.6mm/0.7mm/0.8mm	
Dielectric	Material	Foam PE/Solid PE	
	Diameter	3.6mm-3.8mm	
Shield	1 st shield	Al foil/copper foil	
	2 nd shield	Al-Mg /CCAM/Copper/TC	
	Tri- shield	Al foil/copper foil	
	Qual-shield	Al-Mg /CCAM/Copper/TC	
Jacket	Material	PVC or PE /PVC Degree: 65,68,70,75 /white or black	
	Diameter	6.0mm-6.1mm	
Packing	15m,20m etc short meter with F , DC+BNC connectors .		
	100m coil, 6 rolls per carton .		
	305m with wooden drum/plastic spool, or inner color box, pulling box, outer cartons etc.		

Rg6 Coaxial Cable			
	Options:		Standard Specification
Inner conductor	Material	CCS/COPPER/CCA	1.02mmCopper+4.57mm FPE+ Bonded Al Foil+16*4*0.16mm 67% AL-mg+6.8mmPVC
	Diameter	0.8mm/0.9mm/1.02mm	
Dielectric insulator	Material	Foam PE/Solid PE	
	Diameter	4.57mm-4.9mm	
Shield	1 st shield	Al foil/copper foil	
	2 nd shield	32/48/64/80/96/112/128/144/168 Al-Mg/CCAM/Copper/TC	
		0.10, 0.12, 0.13, 0.14, 0.15, 0.16mm available	
	Tri- shield	Al foil/copper foil	
Qual-shield	Al-Mg /CCAM/Copper/TC		
Jacket	Material	PVC or PE /PVC Degree: 65,68,70,75 /white or black Flame retardant, UV , or UL available	
	Diameter	6.6mm-6.9mm	
Packing	15m,20m etc short meter with 2 F , Angle male /female TV connectors .		
	100m coil, 6 rolls per carton .		
	305m ,500m with wooden drum/plastic spool,or inner color box, pulling box, outer cartons .		
Characteristics	Impedance: 75+/-3 OhmVelocity of Propagation: 85%		
	Return Loss: >=20dB Capacitance :54+3pF/mReference Attenuation [@ 68F . (20.)]		
	5MHz	2.0dB/100 m	
	50MHz	4.5dB/100 m	
	200MHz	8.0dB/100 m	
	450MHz	13dB/100 m	
	550MHz	14.5dB/100 m	
	750MHz	17.5dB/100 m	
	800MHz	18dB/100 m	
	860MHz	19dB/100 m	
	1000MHz	20dB/100 m	





Network line series



Cat5e 4-pair Utp

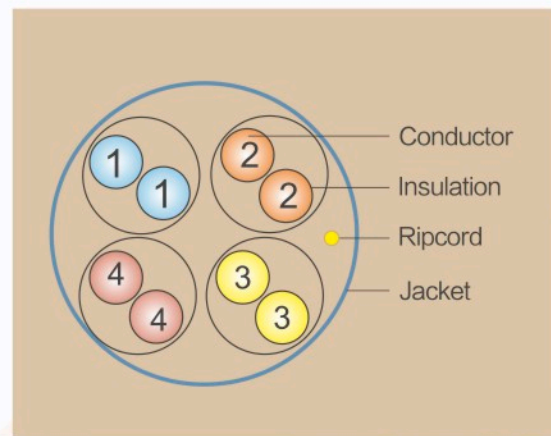

Cat5e 4-pair Ftp

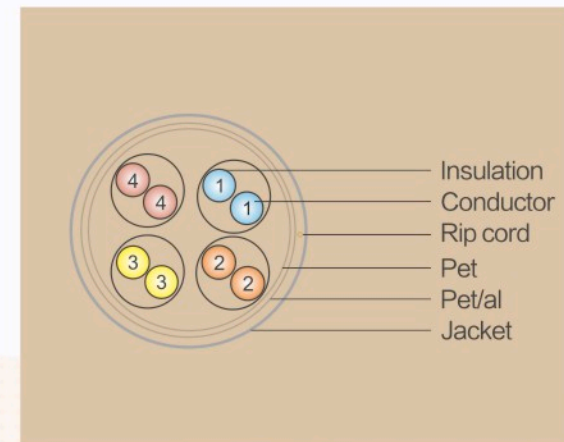

CAT5E UTP NETWORK CABLE

Conductor	Wire Dia	Insulation	Jacket	Packing
CU/CCCA/CCS	24-26AWG	HDPE	PVC/PE/LSZH	305m/Box,2Boxes/CTN
Frequency	Data Performance	Max Data Speed	Max Length	Length Limit at Max Bandwidth
100MHZ	100Mbps	1Gbps	100M	100m

CAT5E FTP NETWORK CABLE

Conductor	Wire Dia	Insulation	Shield	Jacket	Packing
CU/CCCA/CCS	24-26AWG	HDPE	AL FOIL	PVC/PE/LSZH	305m/Box,2Boxes/CTN
Frequency	Data Performance	Max Data Speed	Max Length	Length Limit at Max Bandwidth	
250MHZ	1Gbps	10Gbps	100M	37M	



Cat6 4-pair Utp

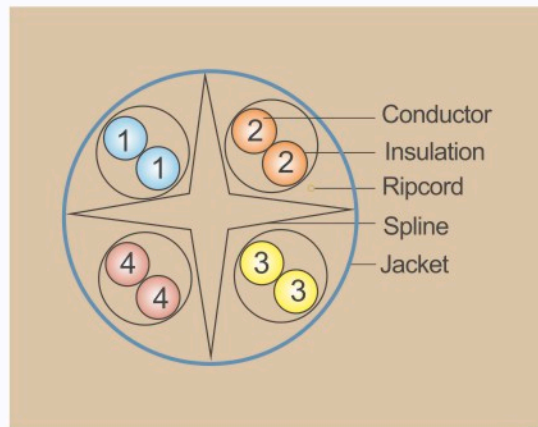

Cat6 4-pair Ftp

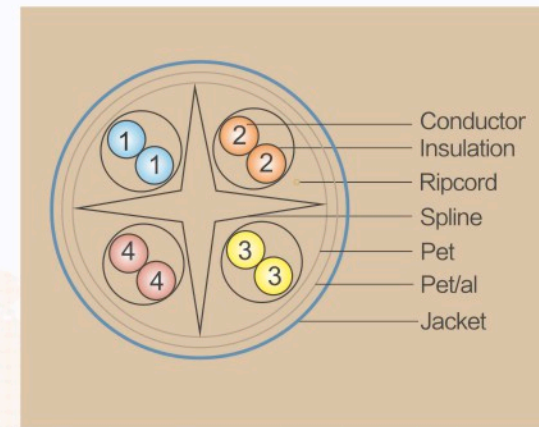

CAT6 UTP NETWORK CABLE

Conductor	Wire Dia	Insulation	Jacket	Packing
CU/CCA/CCS	22-24AWG	HDPE	PVC/PE	305m/Box,2Boxes/CTN

Frequency	Data Performance	Max Data Speed	Max Length	Length Limit at Max Bandwidth
250MHZ	1Gbps	10Gbps	100M	37M

CAT6 FTP NETWORK CABLE

Conductor	Wire Dia	Insulation	Shield	Jacket	Packing
CU/CCA/CCS	22-24AWG	HDPE	AL FOIL	PVC/PE	305m/Box,2Boxes/CTN

Frequency	Data Performance	Max Data Speed	Max Length	Length Limit at Max Bandwidth
250MHZ	1Gbps	10Gbps	100M	37M



PVC Insulated THW Stranded Single Cable

Application

General purpose wiring for lighting and power – residential, commercial, industrial buildings in accordance with the National Electrical Code, maximum conductor temperature of 75° C in wet or dry locations, for circuits not exceeding 600 volts.

Construction

Annealed copper/CCA conductor, PVC insulation.

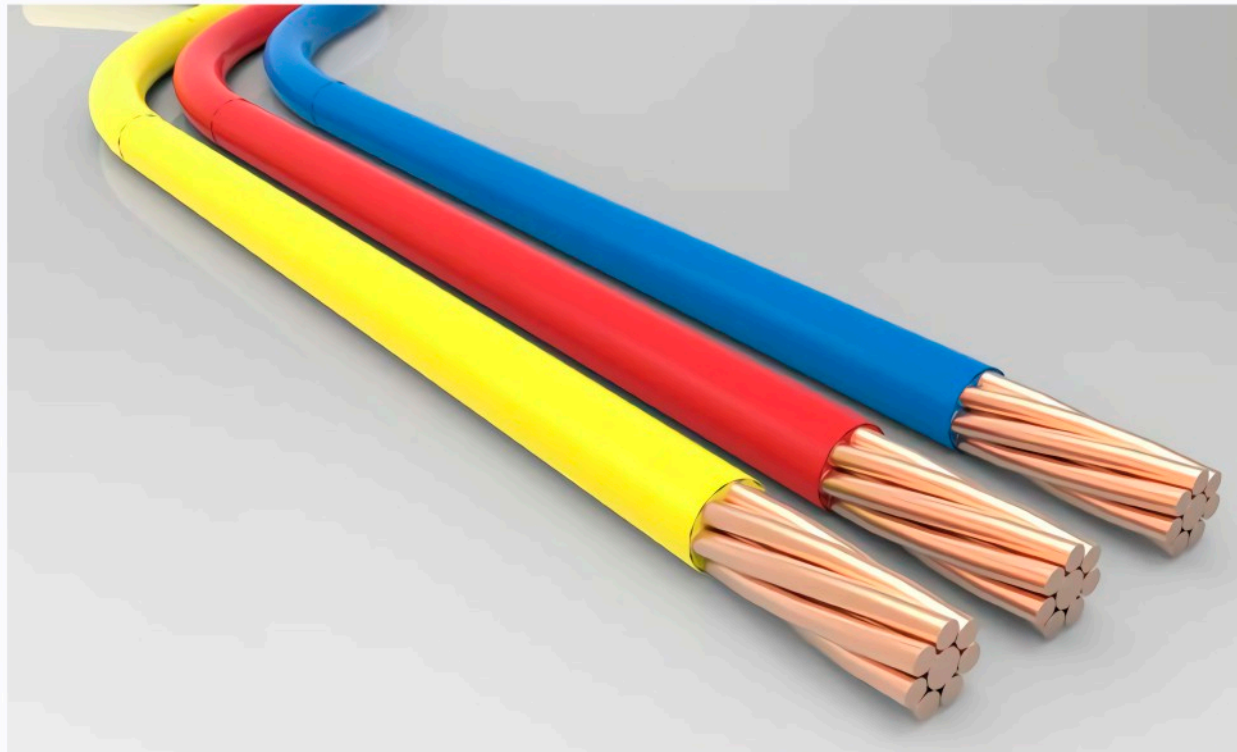

Conductor sectional area(mm ²)	wire number (mm)	wire dia (mm)	conductor dia(mm)	insulator thickness (mm)	outer dia (mm)	weight (mm)
2.5	7	0.66	1.92	0.8	3.5	32
4	7	0.84	2.44	0.8	4.1	47
6	7	1.02	2.98	0.8	4.6	67
10	7	1.33	3.99	1.1	6.2	117
16	7	1.69	4.67	1.5	7.7	186
25	7	2.13	5.88	1.5	8.9	278
35	7	2.51	6.92	1.5	10	375
50	19	1.77	8.15	2	12.3	520
70	19	2.13	9.78	2	13.9	724
95	19	2.51	11.55	2	15.7	981
120	37	2.02	13	2.4	18	1245
150	37	2.24	14.41	2.4	19.4	1508
185	37	2.51	16.16	2.4	21.1	1866
240	37	2.87	18.51	2.4	23.5	2416
300	37	3.22	20.73	2.8	26.5	3041
400	61	2.84	23.51	2.8	29.3	3846
500	61	3.21	26.57	2.8	32.3	4862